

INSTRUMENT TEE C X C X C

ASME BPE DT-4.1.2-11 (DT-29)

Hygienic Clamp Joint: Instrument Tee.



Technical information

Sizes	see table
Connections	Tri-clamp
Material	1.4404 (316L)
Finishes	Interior surfaces SF1
Certificates (st.)	3.1 material
Certificates (opt.)	2.2 surface finish

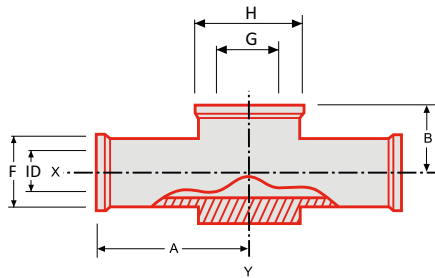

Size	A	B	ØID	ØF	ØG	ØH
½ x 1½"	76.2	22.2	9.4	25	34.8	50.5
¾ x 1½"	76.2	25.4	15.75	25	34.8	50.5
1 x 1½"	76.2	28.6	22.1	50.5	34.8	50.5
½ x 2"	82.6	25.4	9.4	25	47.5	64
¾ x 2"	82.6	28.6	15.75	25	47.5	64
1 x 2"	82.6	31.8	22.1	50.5	47.5	64
1½ x 2"	82.6	38.1	34.8	50.5	47.5	64