

# STRAIGHT CROSS C X C X C X C

## ASME BPE DT-4.1.2-4 (DT-18)

Hygienic Clamp Joint: Straight Cross



### Technical information

Sizes	see table
Connections	Tri-clamp
Material	1.4404 (316L)
Finishes	Interior surfaces SF1
Certificates (st.)	3.1 material
Certificates (opt.)	2.2 surface finish

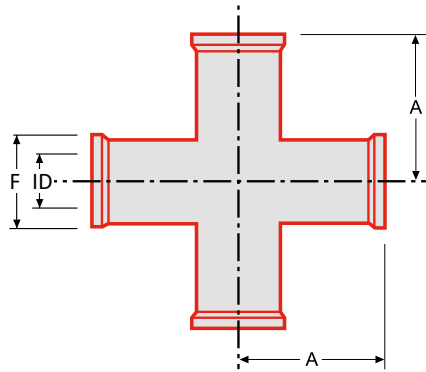

Size	A	ØID	ØF
¼"	57.2	4.57	25
⅜"	57.2	7.75	25
½"	57.2	9.4	25
¾"	60.3	15.75	25
1"	66.7	22.1	50.5
1½"	73.0	34.8	50.5
2"	85.7	47.5	64
2½"	92.1	60.2	77.5
3"	98.4	72.9	91
4"	120.7	97.4	119
6"	181.0	146.7	167