

STRAIGHT TEE C X C X C

ASME BPE DT-4.1.2-4 (DT-18)

Hygienic Clamp Joint: Straight Tee.



Technical information

| | |
|---------------------|-----------------------|
| Sizes | see table |
| Connections | Tri-clamp |
| Material | 1.4404 (316L) |
| Finishes | Interior surfaces SF1 |
| Certificates (st.) | 3.1 material |
| Certificates (opt.) | 2.2 surface finish |

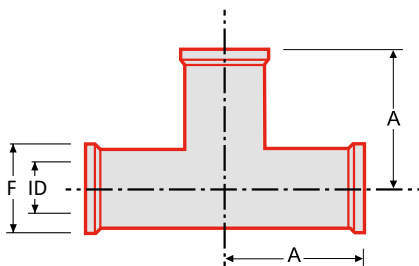

| Size | A | ØID | ØF |
|------|-------|-------|------|
| ¼" | 57.2 | 4.57 | 25 |
| ⅜" | 57.2 | 7.75 | 25 |
| ½" | 57.2 | 9.4 | 25 |
| ¾" | 60.3 | 15.75 | 25 |
| 1" | 66.7 | 22.1 | 50.5 |
| 1½" | 73.0 | 34.8 | 50.5 |
| 2" | 85.7 | 47.5 | 64 |
| 2½" | 92.1 | 60.2 | 77.5 |
| 3" | 98.4 | 72.9 | 91 |
| 4" | 120.7 | 97.4 | 119 |
| 6" | 181.0 | 146.7 | 167 |