



Sanitary  
flow  
equipment



## SPD - DIN SIGHT GLASS Dimensions

### Applications :

Circular sight glass unit model series SPD – DIN based on DIN11851, offer clear process visibility  
Screwed male weld neck for welding into vessel complete with gaskets, sight glass disc and slotted cover nut.  
Nominal sizes : DN50 up to DN150  
Viewing circle : 50 to 150 mm  
Max Pressure atmospheric  
Max Temperature 150°C

### Advantages :

- Fast and simple installation and maintenance
- Suitable for food processing applications
- Extremely compact construction with large viewing area
- No product entrapment
- Sterilizable – Autoclavable

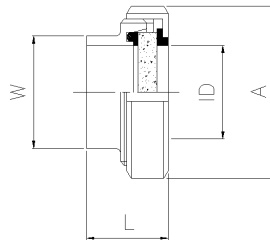

dimensions table

CODE	W	ID	A	L	OD <sup>glass</sup>	Thk	P max	T max borosilicate
SPD-100-X-31A	35,0	26,0	63,0	38,0	40,0	10	atmospheric	150°C
SPD-125-X-31A	41,0	32,0	70,0	42,0	45,0	10	atmospheric	150°C
SPD-150-X-31A	48,0	38,0	78,0	42,0	50,0	9	atmospheric	150°C
SPD-200-X-31A	61,0	50,0	92,0	46,0	60,0	9	atmospheric	150°C
SPD-250-X-31A	79,0	66,0	112,0	50,0	80,0	9	atmospheric	150°C
SPD-300-X-31A	93,0	81,0	127,0	57,0	95,0	9	atmospheric	150°C
SPD-400-X-31A	114,0	98,0	148,0	66,0	112,0	9	atmospheric	150°C
SPD-500-X-31A *	137,0	125,0	178,0	57,0	140,0	12	atmospheric	150°C
SPD-600-X-34A-T *	162,0	150,0	210,0	65,0	165,0	15	atmospheric	150°C

\* only on request -> calciumsodium glass / silicone seal

### Operating Conditions:

Design Pressure only for atmospheric process  
Design Temperature up to 150 °C

### Material:

DIN11851 male-fem. AISI 316L stainless steel  
DIN11851 nut AISI 304 stainless steel  
Insert material Borosilicate glass  
Seals 100°C Silicone + Delrin Lens cushion gasket (std.)  
Seals 150°C PTFE + PTFE Lens cushion gasket

### Optional:

Other seals material available on request

### Surface finish:

SPD product contact surface are finish with Ra<0,8 micron or better

### Marking:

Each SPD Sanitary Flow Indicator is marked with code, material and serial number for full lot traceability

