

# ASEPTIQUIK® C SERIES CONNECTORS

**AseptiQuik® C Connectors** provide quick and easy sterile connections, even in non-sterile environments. AseptiQuik® C connectors' "CLICK-PULL-TWIST" design enables users to transfer media easily with less risk of operator error. The connectors' robust design provides reliable performance without the need for clamps, fixtures or tube welders. Biopharmaceutical manufacturers can make sterile connections with the quality and market availability they expect from the leader in single-use connection.



## SPECIFICATIONS

### PRESSURE

Up to 60 psi, 4.1 bar

### OPERATING TEMPERATURE

39°F to 104°F (4°C to 40°C)

### STERILIZATION

Standard (blue) version:

**Gamma:** Up to 50 kGy irradiation

High Temperature (white) version:

**Gamma:** Up to 50 kGy irradiation

**Autoclave:** Up to 266°F (130°C),  
60 minutes

### TERMINATIONS

3/8 (9.5mm)" and 1/2" (12.7mm) ID hose  
barb, and 3/4" sanitary 1-1/2" sanitary

### MATERIALS

#### Main Components:

Polycarbonate (white)

#### Lock Ring:

Polycarbonate (blue)

#### Pull Tabs:

Polycarbonate (blue, standard version)

Polycarbonate (white, HT version)

#### Caps:

Polypropylene (clear)

#### Seals:

Silicone (clear), platinum-cured

#### Membrane:

Polyethylene (standard version)

Hydrophobic polyethersulfone (HT version),

PTFE strip sticker

WARNING: Pressure, temperature, chemicals, and operating environment can affect the performance of couplings. It is the customer's responsibility to test the suitability of CPC's products in their own application conditions.

## FEATURES

CLICK-PULL-TWIST design

Membrane pull tabs

Robust construction

Integrated lock ring

CPC Click

## BENEFITS

Intuitive three-step connection process reduces risk of operator error

Ensure simultaneous and secure removal of both membranes

Repeatable and reliable performance with no additional hardware required

Secures final connection preventing disassembly

Audible confirmation of completed assembly steps

## TYPICAL FLOW RATE:

**Cv Value Range: 4-14.4**

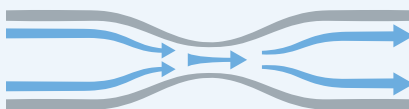

Cv values represent the approximate expected flow rate in gallons per minute of water at room temperature for a 1 PSI pressure drop. The flow is generally constrained by the smallest diameter, which in some cases will be the termination diameter and not the Nominal Flow Path.

## DID YOU KNOW

Did you know that the AseptiQuik G Series Connectors also have 3/8", 1/2", and 3/4" sanitary connections?

# ASEPTIQUIK® C SERIES DIMENSIONS

## COUPLING BODY Polycarbonate - with Blue Pull Tabs



TERMINATION	METRIC EQ.	PART NO.	A	B	C
3/8" HOSE BARB	9.5 mm	AQC17006	2.36" (59.9mm)	2.74" (69.6mm)	0.65" (16.5mm)
1/2" HOSE BARB	12.7 mm	AQC17008	2.36" (59.9mm)	2.95" (74.9mm)	0.89" (22.6mm)
3/4" SANITARY	19.1 mm	AQC33012	2.36" (59.9mm)	2.73" (69.3mm)	0.70" (17.8mm)

## COUPLING BODY Polycarbonate - HT with White Pull Tabs



TERMINATION	METRIC EQ.	PART NO.	A	B	C
3/8" HOSE BARB	9.5 mm	AQC17006HT	2.36" (59.9mm)	2.74" (69.6mm)	0.65" (16.5mm)
1/2" HOSE BARB	12.7 mm	AQC17008HT	2.36" (59.9mm)	2.95" (74.9mm)	0.89" (22.6mm)
3/4" SANITARY	19.1 mm	AQC33012HT	2.36" (59.9mm)	2.73" (69.3mm)	0.70" (17.8mm)

## COUPLING INSERT Polycarbonate - with Blue Pull Tabs



TERMINATION	METRIC EQ.	PART NO.	A	B	C
3/8" HOSE BARB	9.5 mm	AQC22006	2.50" (63.5mm)	2.90" (73.7mm)	0.65" (16.5mm)
1/2" HOSE BARB	12.7 mm	AQC22008	2.50" (63.5mm)	2.99" (75.9mm)	0.89" (22.6mm)
3/4" SANITARY	19.1 mm	AQC44012	2.50" (63.5mm)	2.80" (71.1mm)	0.70" (17.8mm)

## COUPLING INSERT Polycarbonate - HT with White Pull Tabs



TERMINATION	METRIC EQ.	PART NO.	A	B	C
3/8" HOSE BARB	9.5 mm	AQC22006HT	2.50" (63.5mm)	2.90" (73.7mm)	0.65" (16.5mm)
1/2" HOSE BARB	12.7 mm	AQC22008HT	2.50" (63.5mm)	2.99" (75.9mm)	0.89" (22.6mm)
3/4" SANITARY	19.1 mm	AQC44012HT	2.50" (63.5mm)	2.80" (71.1mm)	0.70" (17.8mm)

## PRODUCT DIMENSIONS

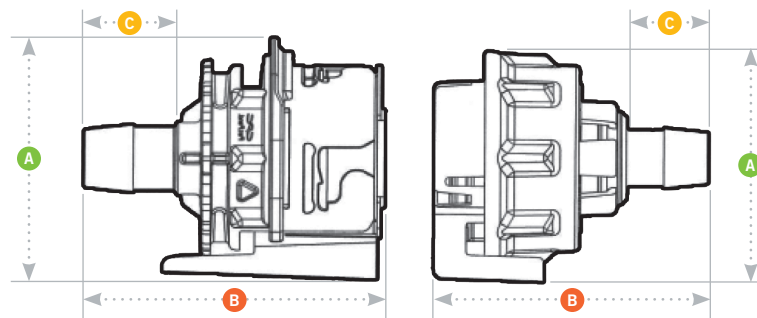

- A = Height/Diameter
- B = Total Length
- C = Hose Barb Length

## AQC ASSEMBLY PROCEDURE

### STEP 1

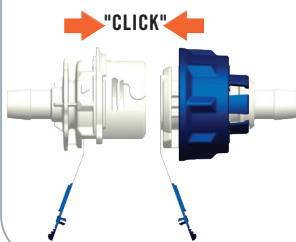

Align male and female connectors using the START alignment feature of the blue lock ring with the rib indicator of the white body. Insert the two halves together.

### STEP 1



Align male and female connectors using the START alignment feature of the blue lock ring with the rib indicator of the white body. Insert the two halves together.

### STEP 1



Align male and female connectors using the START alignment feature of the blue lock ring with the rib indicator of the white body. Insert the two halves together.