

Kest-Lock Pipe Inline

SPECIFICATIONS

Material Grade	EN 1.4435	ASTM 316L or ASME 316L
Material requirement	EN 10 272/10028-7	A479/A240 or SA479/SA240
Documentation	Heat Certificate 3.1 acc. to EN 10 204	
Surface finish	Ra≤[0.5 μm] [20 μin] internal (polished)	Ra≤[1.6 μm] [63 μin] outer
Design Temperature	[-80°C to 200°C] [112°F to 392°F]	
Design Pressure	[-1 bar(g) to + 10 bar(g)] [-14.5 psi to 145 psi]	
Marking	Marked with material grade and heat number	
Packing	Sealed in vacuum plastic bag, labelled with art. number and packed in a box	
Gaskets	The Kest-Lock is designed for use of standard gaskets acc. to ISO 2852 type B	
Standard	The Kest-Lock is designed for clamp couplings acc ISO 2852, ASME BPE, DIN 32 676	
Quality Assurance	Each product is controlled and tested acc. to Kest Technology quality assurance system	

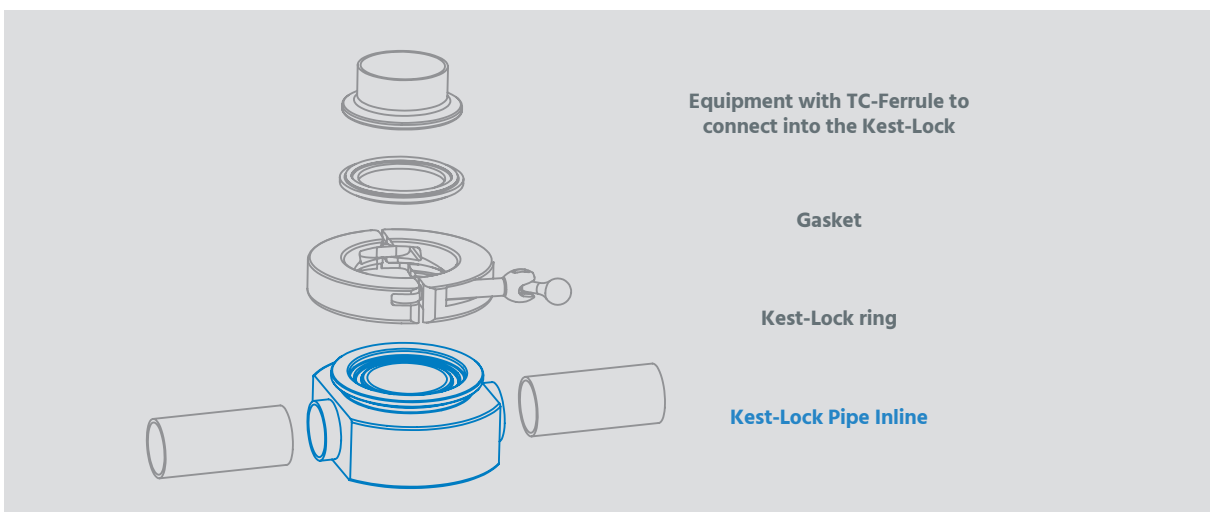

Kest-Lock Pipe Inline

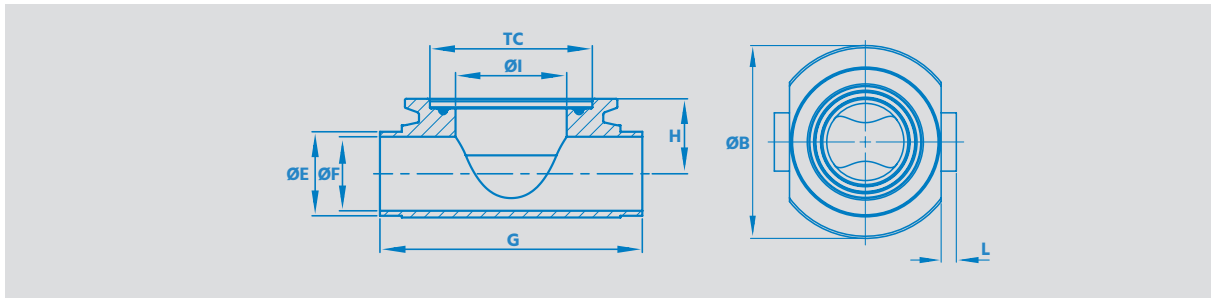

REF. NO	PRODUCT CODE	TC mm [in]	ØI mm [in]	ØE mm [in]	ØF mm [in]	G mm [in]	H mm [in]	L mm [in]	ØB mm [in]
For pipe ASTM A 269/270									
100426	KLPI-TC50-ASTM1.5-ASTM0.5-BE	50.5 [1.988]	34.8 [1.370]	12.7 [0.500]	9.4 [0.370]	112 [4.409]	16.05 [0.632]	21 [0.827]	85 [3.346]
100312	KLPI-TC50-ASTM1.5-ASTM0.75-BE	50.5 [1.988]	34.8 [1.370]	19.1 [0.750]	15.8 [0.622]	112 [4.409]	20 [0.787]	21 [0.827]	85 [3.346]
100311	KLPI-TC50-ASTM1.5-ASTM1.0-BE	50.5 [1.988]	34.8 [1.370]	25.4 [1.000]	22.1 [0.870]	112 [4.409]	22.4 [0.882]	21 [0.827]	85 [3.346]
100313	KLPI-TC50-ASTM1.5-ASTM1.5-BE	50.5 [1.988]	34.8 [1.370]	38.1 [1.500]	34.8 [1.370]	112 [4.409]	28.75 [1.132]	21 [0.827]	88 [3.465]
100513	KLPI-TC50-ASTM1.5-ASTM2.0-BE	50.5 [1.988]	34.8 [1.370]	50.8 [2.000]	47.5 [1.870]	112 [4.409]	35.1 [1.382]	21 [0.827]	93 [3.661]
100745	KLPI-TC50-ASTM1.5-ASTM2.5-BE	50.5 [1.988]	34.8 [1.370]	63.5 [2.500]	60.2 [2.370]	112 [4.409]	41.45 [1.632]	21 [0.827]	100 [3.937]