

WELDING TOOLS AND PROCEDURES

Kest products are to be considered as pressure parts. The welding operation is essential for the functionality of the product during its entire lifetime either it is a tank plate for a mixer or a tank flange for our popular Kest-Lock connection.

In order to secure this installation process Kest has developed a range of welding tools and welding instructions for each product line.

During quotation procedures we always add the welding tool to the quote to make sure this important step is not missed. In the case you as a customer already has the proper welding tool you can ignore this item on the quote since our welding tools are reusable for the same part number.

Welding tool - tank plate for Kest Mixer

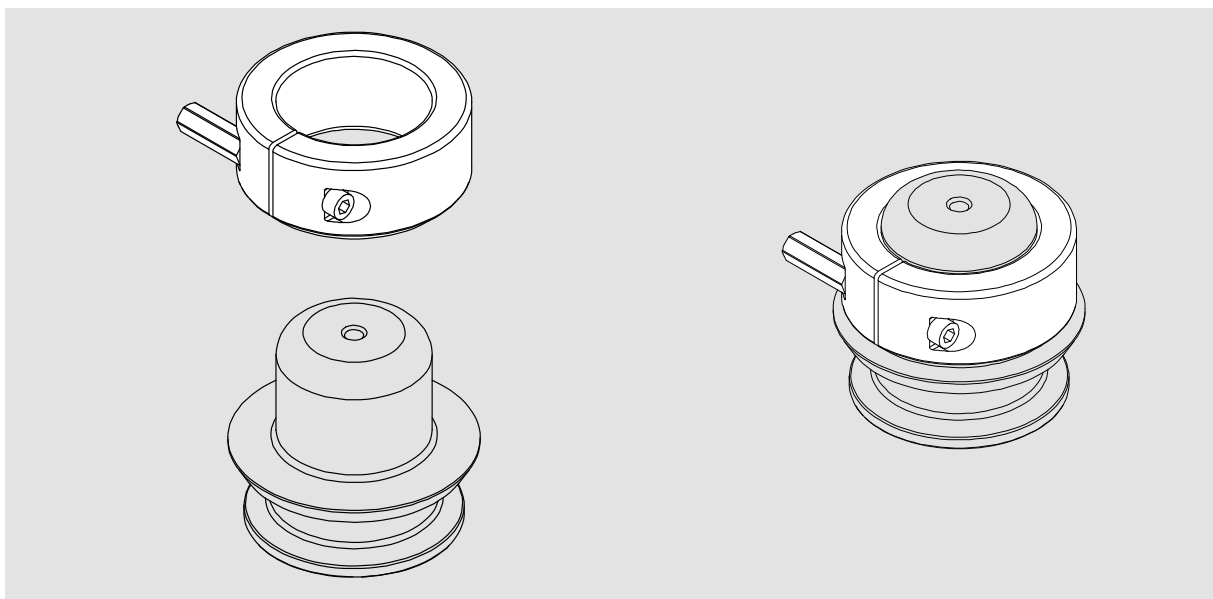

Welding tool - tank flange for Kest-Lock connection

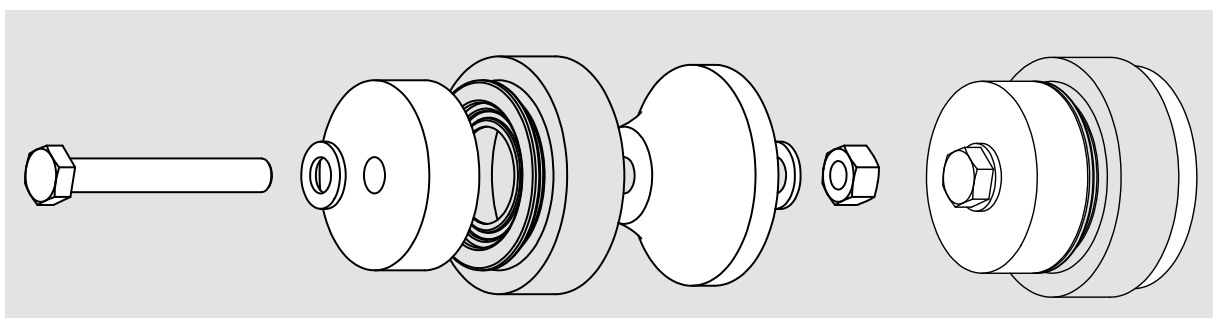

ALWAYS USE A WELDING TOOL AND FOLLOW THE WELDING GUIDELINE WHEN INSTALLING A KEST MIXER TANK PLATE OR KEST-LOCK TANK FLANGE