

MUSHROOM VENTS

Mushroom Vents with Tri-Clamp connection

These vents are constructed of 316L stainless steel with a solid radiused and panned top. The vents may be installed on CIP tanks to prevent foreign materials from entering the tank. Mushroom vents prevent any pressure build from occurring in non-pressure tanks such as water storage.



Technical information

Sizes	½" to 2"
Connections	Tri-Clamp
Material	316L
Finishes	Interior surfaces SF1
Certificates (standard)	3.1 material

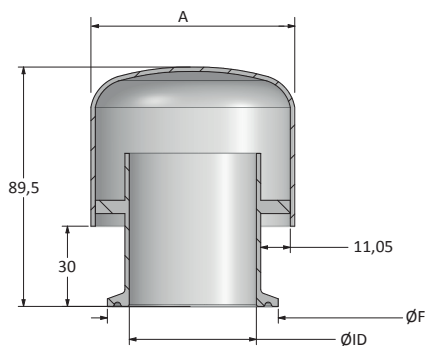

Size	A	ØID	ØF
½"	25.4	9.4	25
1"	38.1	22.1	50.5
1½"	63.5	34.8	50.5
2"	76.2	47.5	64



ROMYNOX

RX: F-U

These are standard items. We also deliver other sizes, according to ISO, DIN and SMS. For more and the latest information use the QR-code to go to the website.