

Sanitary Thermodynamic Steam Traps

Stainless steel disc is the only moving part. Low initial cost is less expensive than repairable technologies. Handles water hammer and superheat. Blast discharge quickly draws condensate and helps maintain system temperature.

Resists both internal and external corrosion. Audible discharge cycle makes checking operation simple.



Technical information

Sizes	1/2", 3/4" and 1"
Max. pressure	operating: 0-10 bar allowable: 15 bar
Max. temperature	454 °C
Connections	Tri-Clamp
Material	1.4404 (316L)
Finishes	0,5 Ra, SF1
Certificates	3.1 - Solid Bar

Options:

- Other sizes on request.
- Enhanced surface finishes and electropolishing.

Specification

Steam Trap shall be of the thermodynamic design. Body shall be of 316L stainless steel construction. Trap body shall contain an integral seat. Cover shall seal to body without gaskets or seals. Trap shall be suitable for pressures through 10 bar. Trap end connections shall be hygienic clamp and accommodate mating connection sizes of 1/2, 3/4 and 1 inch. Trap shall function installed in any pipe configuration.

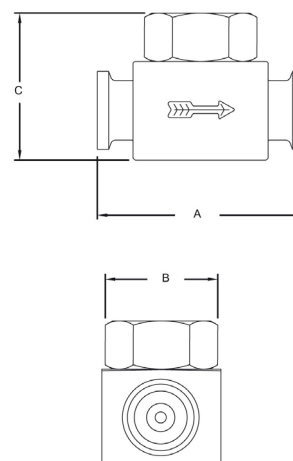

A	B	C	Weight (kg)
66	38	51	0.59

Maximum Capacity

kg/hr (10°F Below Saturation)

Orifice	Differential bar						
	0.34	0.7	1.4	3.4	6.9	8.6	10.3
0.141	97	107	120	156	202	220	236