

DT7 – DT-4.1.1-10 ELBOW 92° W X W

ASME BPE DT-4.1.1-10



For reliable processes in the pharmaceutical industry and biotechnology, ROMYNOX is the one-stop destination. We provide stainless steel fittings that comply with international ASME BPE standards and marking, with dimensions specified in ASME BPE Part DT-3-1. ASME BPE pipe fittings are the best choice for high cleanliness requirements in biological control.



Technical information

Sizes	see table
Connections	Weld
Material	1.4404 (316L) Also available in: Hastelloy 2.4602 / C22

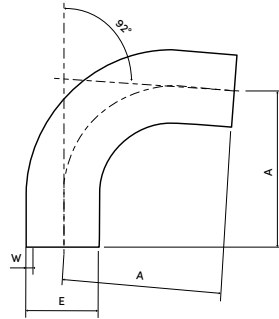

Size	A	ØE	W
¼"	66.7	6.35	0.89
⅜"	66.7	9.53	0.89
½"	76.2	12.7	1.65
¾"	76.2	19.05	1.65
1"	76.2	25.4	1.65
1½"	95.3	38.1	1.65
2"	120.7	50.8	1.65
2½"	139.7	63.5	1.65
3"	158.8	76.2	1.65
4"	203.2	101.6	2.11
6"	292.1	152.4	2.77