

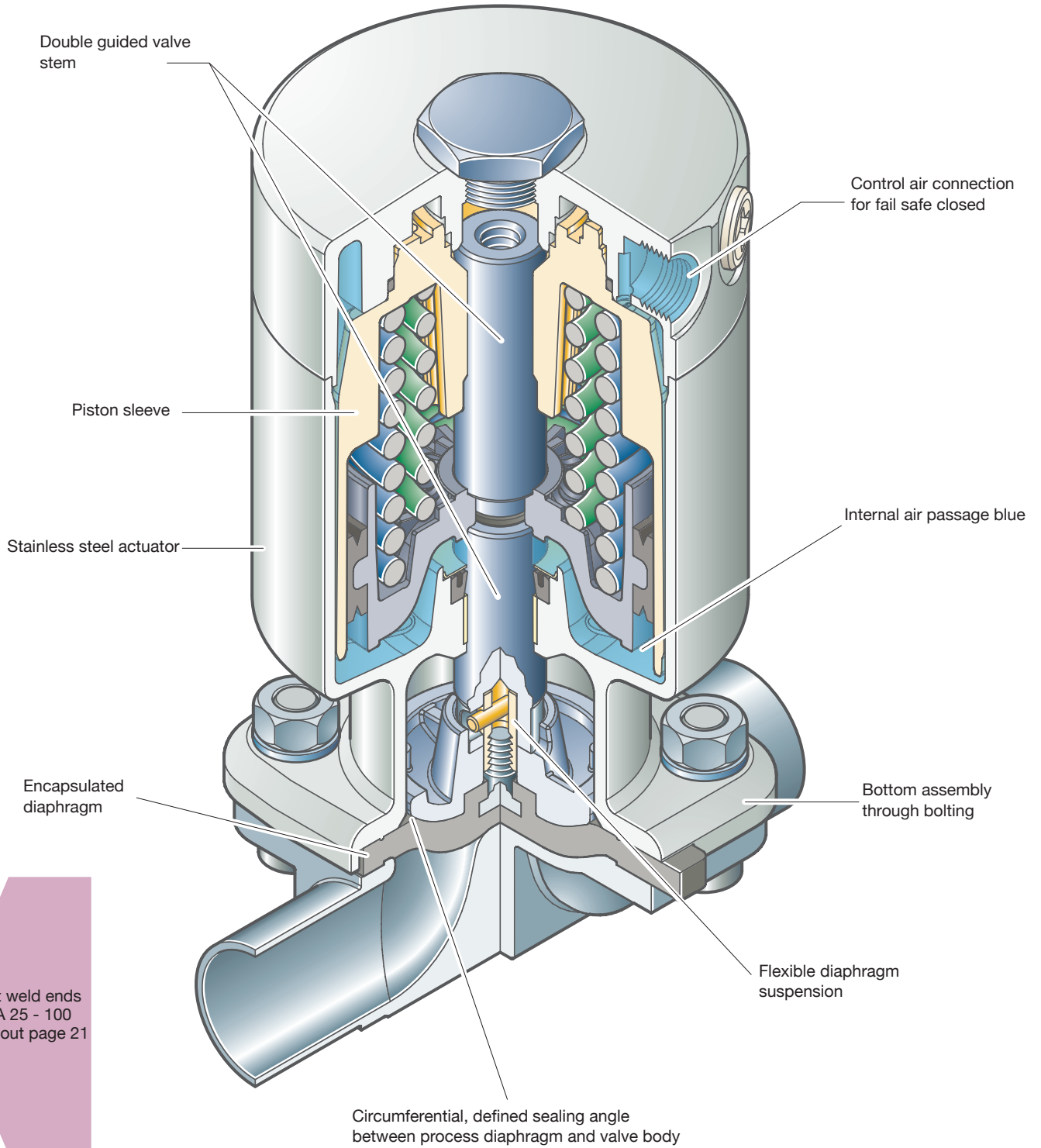

Steripur 417

Pneumatically Operated Valve DN 15 - 50mm (3/4" - 2 1/2")



Butt weld ends
MA 25 - 100
Fold out page 21

Pneumatically Operated Valve DN 15 - 100 mm (3/4" - 4")



DN 15 - 50 Cf. 4, 5, 6

Features

- High cycle stainless steel piston actuator
- Compact design, the outside diameter of the actuator is the same size as the bonnet flange
- Advantages in multiport bodies and manifold valve assemblies
- Control air connection in flow direction
- CDSA sealing concept, see page 32
- Flexible diaphragm suspension
- Encapsulated diaphragm
- Clean and polished exterior design ideal for sterile wash downs

Optional

- Available with a wide range of control equipment and accessories see page 118 to 125, also for retrofitting
- Control air connection 90° to flow direction
- Autoclavable

Technical Data

Control function (Cf.): Pneumatically operated
 Fail safe close (NC): Cf. 1 & 4
 Fail safe open (NO): Cf. 2 & 5
 Double acting (DA): Cf. 3 & 6

Direction

Control connection: At Cf. 4, 5 & 6, in flow direction, standard
 At Cf. 1, 2 & 3, 90° to flow direction

Max. working pressure: Unidirectional (delta p = 100%)

Diaphragm	DN 15-50 (1/2"-2")	DN 65-80 (2,5"-3")	DN 100 (4")
EPDM	10 bar (150 psi)	7 bar (100 psi)	6 bar (87 psi)
PTFE	8 bar (115 psi)	6 bar (87 psi)	5 bar (72 psi)

Higher working pressure may be achieved with different actuator. Please consult a SED factory representative for working pressure above the indicated maximum.

Max. working temperature: 160°C (320°F) dependent on application
 Control pressure: Cf. 1 & 4 DN 15-50 4,5 - 8 bar(65-115 psi)
 Cf. 1 & 4 DN 65-80 5 - 8 bar(72-115 psi)
 Cf. 1 & 4 DN 100 6 - 8 bar(87-115 psi)
 Cf. 2, 3, 5 & 6 DN 15-80 4,5-6 bar(65-87 psi)
 Cf. 2, 3, 5 & 6 DN 100 5,5-7 bar(80-100 psi)

Diaphragm material: EPDM or PTFE
 Valve body material: Forged 1.4435/ 316 L ASME/BPE
 Investment cast 1.4435/ 316 L
 Other alloys

End connection: Butt weld ends see fold out page 21
 Clamps and flanges see page 22 and 23
 Special ends

Actuators suitable for: Two-Way bodies
 Welded configurations
 T-bodies
 Multiport bodies
 Tank bottom bodies

Flow rate: Kv in m³/h (Cv in GPM) see page 9

Diaphragm size: MA see table below

Technical data also valid for multiport valve.

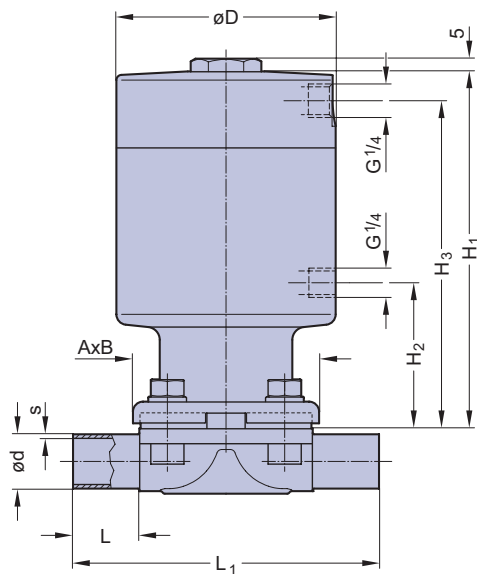

DN 15 - 50

Butt weld ends
 MA 25 - 100
 Fold out page 21

DN (mm)	MA	Dimensions (mm)							Total weight ca. (kg)		Filling volume (NL)	
		L	L ₁	A x B	H ₁	H ₂	H ₃	D	Investment cast	Forged	NC	NO/DA
15-25	25	25	120	73x79	140	-	129 ^{1,2}	86	2,6	2,7	0,15	0,14
32-40	40	25	153	96x105	167	-	155 ^{1,2}	111	5,0	6,0	0,34	0,30
50	50	30	173	111x130	190	-	176 ^{1,2}	136	9,0	10,0	0,60	0,54
65	80	30	216	170x190	309	135 ¹	285 ²	179	23,0	26,0	1,80	2,35
80	80	30	254	170x190	309	135 ¹	285 ²	179	23,0	26,0	1,80	2,35
100	100	30	305	ø238	318	143 ¹	295 ²	179	33,0	31,0	1,80	2,47

¹ NC, ² NO/DA

Valve type overview see page 26 and 27.
 Ordering key see page 59 to 61..