

Pneumatically operated Valve DN 8 - 20 mm (3/8" - 3/4")



Cf. 1, 2 & 3



Cf. 4 & 5

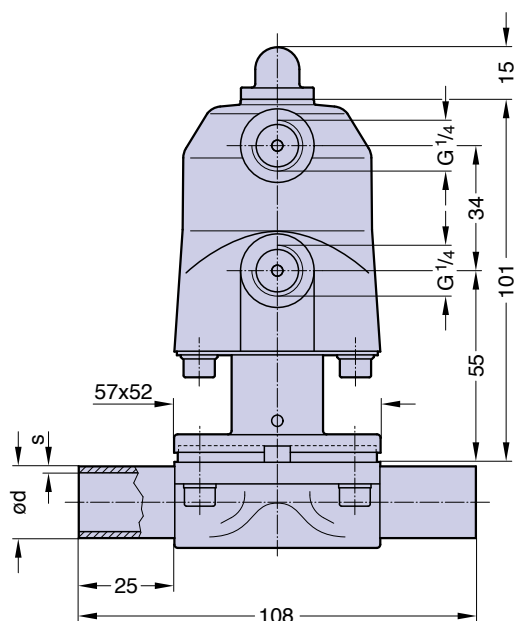

Features

- Efficient plastic piston actuator with stainless steel distance piece
- Control air connection 90° to flow direction
- Flexible diaphragm suspension
- Encapsulated diaphragm
- Optical indicator
- Compact design, the outside diameter of the actuator is the same size as the bonnet flange
- CDSA sealing concept, see page 32

Optional

- Available with a wide range of control equipment and accessories see page 132 to 139, also for retrofitting
- Control air connection in flow direction

Technical Data

Control function (Cf.):	Pneumatically operated
	Fail safe close (NC): Cf. 1 & 4
	Fail safe open (NO): Cf. 2 & 5
	Double acting (DA): Cf. 3
	At control function NO/DA higher control pressure than required may affect the lifetime of the working diaphragm.
Direction	
Control connection:	
Max. working pressure:	At Cf. 1, 2 & 3, 90° to flow direction, standard
	Unidirectional (delta p = 100%)
	EPDM diaphragm 8 bar (115 psi)
	PTFE diaphragm 7 bar (100 psi)

Higher working pressure may be achieved with different actuator. Please consult a SED factory representative for working pressure above the indicated maximum.

Max. working temperature:	
Control pressure:	160°C (320°F) dependent on application
	Cf. 1 4,2 - 7 bar (60 - 100 psi)
Diaphragm material:	Cf. 2, 3 4 - 5 bar (60 - 72 psi)
Valve body material:	EPDM or PTFE
	Forged 1.4435/ 316 L ASME/BPE
	Investment cast 1.4435/ 316 L
End connection:	Other alloys
	Butt weld ends see fold out page 21
	Clamps and flanges see page 22 to 24
Actuators suitable for:	Special ends
	Two-Way bodies
	Welded configurations
	T-bodies
	Multiport bodies
	Tank bottom bodies
Flow rate:	Kv in m ³ /h (Cv in GPM) see page 9
Diaphragm size:	MA 10
Weight:	ca. 0,8 kg
	Technical data also valid for multiport valve.

DN (mm)	MA	Filling volume (NL)	
		NC	NO/DA
8-20	10	0,027	0,027